

- ZONING LEGEND**
- R-1 RURAL RESIDENTIAL DISTRICT
 - R-2 SUBURBAN RESIDENTIAL DISTRICT
 - R-3 RESIDENTIAL DISTRICT
 - R-4 MULTI-FAMILY DISTRICT
 - CB CENTRAL BUSINESS DISTRICT
 - GB GENERAL BUSINESS DISTRICT
 - OP OFFICE & PROFESSIONAL DISTRICT
 - HI HIGHWAY INTERCHANGE DISTRICT
 - CP CENTRAL PROFESSIONAL DISTRICT
 - LI LIGHT INDUSTRIAL DISTRICT
 - I INDUSTRIAL DISTRICT
 - AD AIRPORT DISTRICT OVERLAY
 - C CONSERVATION DISTRICT

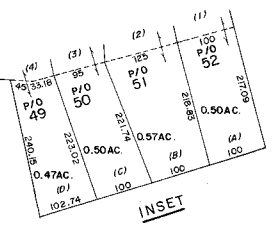

30A - A-11 DROPPED 1985
 30A - A-12
 30A - A-17

FOR TAX PURPOSES ONLY
 NOT TO BE USED FOR CONVEYANCE
 PREPARED BY
GENERAL MAPPING INC.
 Tolland, Ct. 06097

LEGEND

PROPERTY LINE	SINGLE
ORIGINAL LOT LINE	DASHED
EDGE OF PAVEMENT OR ROADWAY	DOTTED
BUILDING	SOLID
WATER BODY NUMBER	W
RIGHT-OF-WAY	W
TOWN LINE	---
COUNTY LINE	---
TRIM	20
PARCEL NUMBER	20
LEGAL OWNER	20
WATER BODY NUMBER	W
DEED LOT NUMBER	20
BLOCK LETTER	20
ZONING LINE	---

REVISIONS

1 GENERAL MAPPING INC. 12-31-75	TOWN ENGINEER. 05-17-02	17
2 GENERAL MAPPING INC. 12-31-77		18
3 GENERAL MAPPING INC. 12-31-79		19
4 GENERAL MAPPING INC. 12-31-79		20
5 GENERAL MAPPING INC. 12-31-80		21
6 GENERAL MAPPING INC. 12-31-81		22
7 GENERAL MAPPING INC. 12-31-82		23
8 TOWN ENGINEER 2-9-88		24

TOWN OF OXFORD
 BOARD OF ASSESSORS
 OXFORD, MASS.

MAP NO. 30A
 DATE, AERIAL PHOTOGRAPHY: 4-27-74 DATE, MAP: 9-1-75
 PHOTO NO.: 3-28 & 9-82 SCALE: 1" = 100'

REVISED & REPRINTED BY
 CARTOGRAPHIC ASSOCIATES, INC.
 LITTLETON NH 03561